

Box: PLOCK 1

BIKE	HONDA CB 1300	PART NO.	EHA - 81
YEAR	2003 - ON	FIT KITS	OVAL Z039.11055 // ROUND Z039.10055
NOTES	Where not supplied use original fittings	FEATURES	DB KILLER Z038.10120

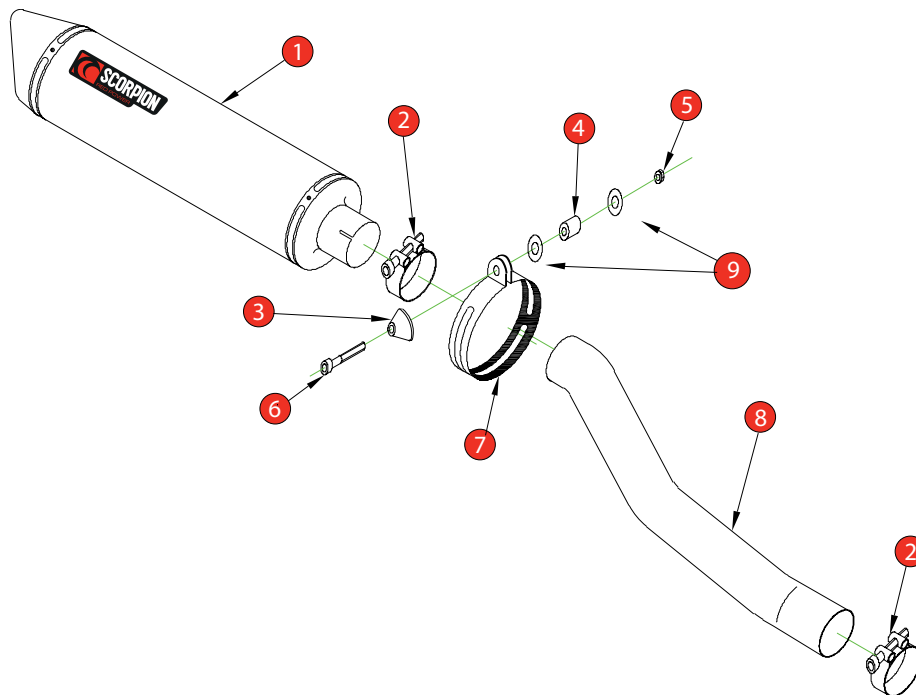

- |   |                                      |
|---|--------------------------------------|
| 1 450mm Silencer ESC 50                                 | 8 Connecting Pipe CP 139             |
| 2 2 x 51-55mm Band Clamp (Z016.10002)                   | 9 2 x M8 x 26mm Washers (Z017.10825) |
| 3 Aluminium Bolt Finisher (Z026.20068)                  |                                      |
| 4 15mm Aluminium Spacer (Z026.10005)                    |                                      |
| 5 M8 Nyloc Nut (Z017.10062)                             |                                      |
| 6 M8 x 60mm Cap Head Bolt (Z017.10080)                  |                                      |
| 7 Composite Silencer Strap (R-Z038.10090)(O-Z038.10088) |                                      |

E-MARK ROUND	SCDB-RS e4 2035
E-MARK OVAL	SCDB-OS e4 2072
ISSUE NO.	6
DATE	18/08/08
AUTHORISED	S.Northrop
CHECKED	

**NOTE:** ENSURE SCORPION SYSTEM IS CLEAR OF MOVING PARTS AND ALL ORIGINAL FUNCTIONS WORK CORRECTLY.



A) Remove original exhaust from bike, taking care to keep all original components in a safe place.

B) Refit Scorpion exhaust as per line diagram above.

C) When fitted take bike for a short ride to ensure all functions are correct.

D) When bike & exhaust are cool enough check all nuts and bolts are still secure.